

CB Chelsea Lane Sampler

2006-2007 BOM Sampler Quilt from BOMQuilts.com & CheckerBerrieQuiltShop.com

An original design of traditional sampler quilt squares surrounded by a stunning framed border designed with "Chelsea Lane" fabric by P & B Textiles.

April 25, 2007 - Block 10 - Page 1







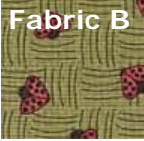

Finished Quilt to Measure 48" x 61"

Finished Blocks to Measure 14" x 14"



Cutting Instructions for Block 10

Fabric A	Fabric B	Fabric C	Fabric D	Fabric E	Fabric F
 <p>Cut TWO (2) 3 1/8" squares</p> <p>-----</p> <p>Cut FOUR (4) 2 7/8" squares</p>	 <p>Cut EIGHT (8) 1 5/8" squares.</p> <p>-----</p> <p>Cut TWO (2) 3 1/8" square</p>	 <p>Cut EIGHT (8) 1 5/8" squares</p> <p>-----</p> <p>Cut TWO (2) 3 1/8" squares then cut this square diagonally ONE time.</p> 	 <p>Cut FOUR (4) 2 7/8" x 10 1/2" strips then cut the ends of EACH strip off at a 45% angle (see image below)</p>	 <p>Cut FOUR (4) 3 1/8" squares</p> <p>-----</p> <p>Cut FOUR (4) 2 7/8" squares</p>	 <p>Cut FOUR (4) 2 1/8" x 7 3/4" strips then cut the ends of EACH strip off at a 45% angle (see image below)</p>

Measure over the SIDE size from edge and draw a diagonal line from the bottom corner to your mark. Repeat on opposite side

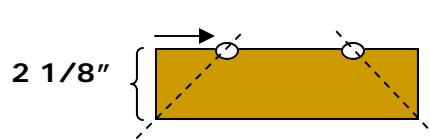
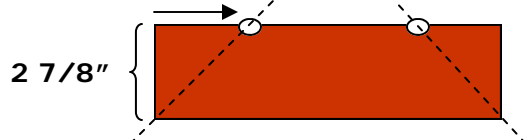

CB Chelsea Lane Sampler

2006-2007 BOM Sampler Quilt from BOMQuilts.com & CheckerBerrieQuiltShop.com

An original design of traditional sampler quilt squares surrounded by a stunning framed border designed with "Chelsea Lane" fabric by P & B Textiles.

April 25, 2007 - Block 10 - Page 2



Sewing Instructions for Block 10

- Let's begin this month with some LINES! Draw a diagonal line, from corner-to-corner, on ALL of your Fabric E 3 1/8" squares. Next, sew TWO (2) of these Fabric E squares to the right side of TWO (2) Fabric A 3 1/8" squares, 1/4" and on BOTH sides of the line you drew. Then, cut your half-square triangles apart ON the diagonal line you drew. You will end up with FOUR (4) half-square triangles. Then, repeat the same process for your Fabric B 3 1/8" squares, sewing to the remaining Fabric E squares. You will finish with a total of EIGHT (8) half-square triangles.

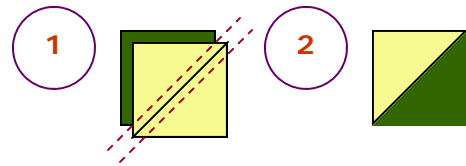

- Sew your four corner four-patch blocks from Fabrics B & C as shown. Repeat three more times for a total of FOUR (4) four-patch corners: _____ →



- Begin piecing the center of your block, as shown:

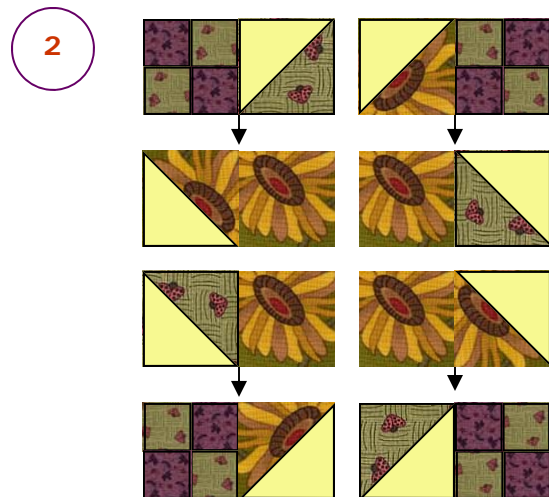
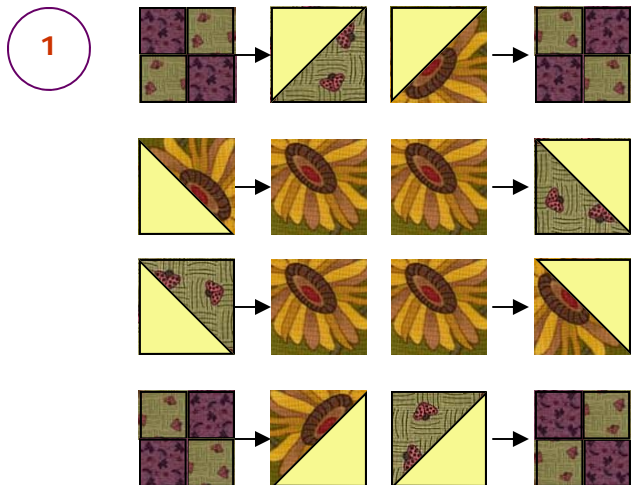

CB Chelsea Lane Sampler

2006-2007 BOM Sampler Quilt from BOMQuilts.com & CheckerBerrieQuiltShop.com

An original design of traditional sampler quilt squares surrounded by a stunning framed border designed with "Chelsea Lane" fabric by P & B Textiles.

April 25, 2007 - Block 10 - Page 3



Sewing Instructions for Block 10 (continued)

4) Now, assemble the rest of the center of your block:

1

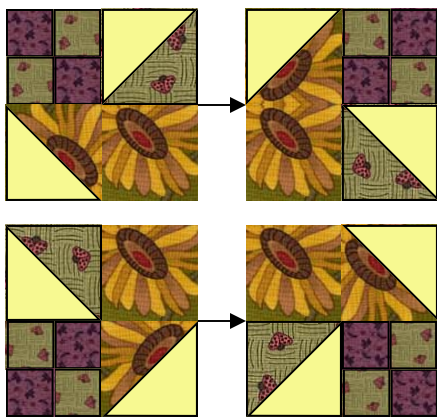

2

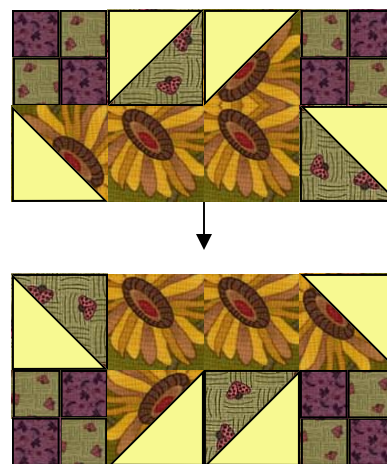

5) Finally, complete the rest of your block!

A -- sew 2 Fabric E strips to the left and right of your center half-square triangle square.

B -- sew your 4 four-square blocks to the ends of 2 of your Fabric E strips.

C -- sew the four-square strips made in B above to the top and bottom of your center half-square triangle rectangle.

D -- sew the 4 Fabric D strips to this center block.

E -- sew the Fabric F strips to the long edge of your Fabric C triangles.

F -- sew the center block to the corner triangles you made in E above!

Finished block will measure 14 5/8" square.



Now, you're ready for Block 11!

© BOMQuilts.com - All Rights Reserved
For Personal Use ONLY