



“Botanical Beauty”

2016 Block of the Month Quilt

An Original Quilt Designed by TK Harrison from BOMquilts.com

Brought to you by BOMquilts.com, Camelot Fabrics, The Warm Company & Aurifil Thread



BOMquilts.com

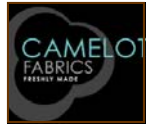

Botanical Beauty
Block #5
June 20, 2016

“Botanical Beauty” features rich and luxurious fabrics with blocks designed to add a touch of whimsy with basic modern flares!

www.BOMquilts.com

Finished Quilt = 70" x 85"

Finished Blocks for Quilt = 15"

Unfinished Blocks for Quilt = 15 1/2"

Fabric: “Botanical” designed by Alisse Courter from Camelot Fabrics

Find a quilt shop who carries the “Botanical” fabric at

www.camelotfabrics.com/find-a-store

Purchase Aurifil Thread from Aurifil

Find a shop to purchase Warm & Natural batting from www.WarmCompany.com

All Seams a precise 1/4" ~ Press in the direction of the arrows.

Read ALL Instructions Before Beginning

These cutting instructions are for the “Botanical Beauty” Block #5:

Fabric	Cutting Instructions
Twig in Iron	Cut TWO (2) 2" x 15 1/2" strips
Twig in Iron	Cut TWO (2) 2" x 12 1/2" strips
White	Cut TWO (2) 2" x 12 1/2" strips
White	Cut TWO (2) 3 1/2" x 9 1/2" strips
White	Cut ONE (1) 2" x 9 1/2" strip
White	Cut FOUR (4) 2 3/4" squares. On the back side of the squares, draw a diagonal line, corner-to-corner, ONE (1) time.
Leaves in White	Cut ONE (1) 2 3/4" x 7 1/2" strip
Tossed Flowers in White	Cut ONE (1) 2 3/4" x 7 1/2" strip



Aurifil thread suggestions:

#5605, #5158, #5975, #5865,
#5021, #5835



**Warm & Natural Batting: Full Bed
Sized package**



“Botanical Beauty”

2016 Block of the Month Quilt

An Original Quilt Designed by TK Harrison from BOMquilts.com

Brought to you by BOMquilts.com, Camelot Fabrics, The Warm Company & Aurifil Thread



BOMquilts.com



**Botanical Beauty
Block #5
June 20, 2016**

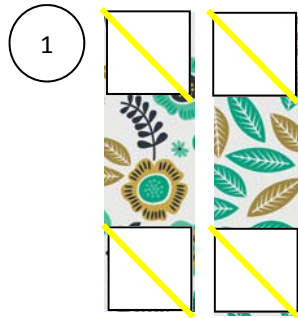

Place the 2 3/4" WHITE square on the 2 3/4" x 7 1/2" *TOSSED FLOWERS IN WHITE* strip, matching up the upper corners of the two fabrics, right sides together. Sew the blocks together ON the line you drew. Cut away the corner and press in the direction of the *TOSSED FLOWERS IN WHITE* strip. Repeat for the opposite end of the *TOSSED FLOWERS IN WHITE* strip, matching up the bottom corners of the fabrics. Follow these same instructions, substituting the *TOSSED FLOWERS IN WHITE* fabric for the *LEAVES IN WHITE*.

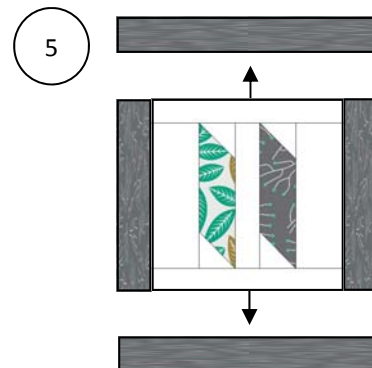
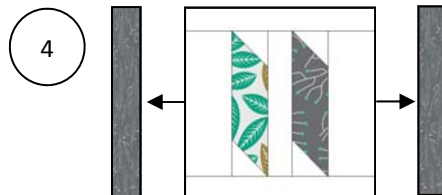
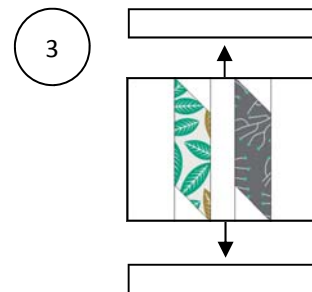
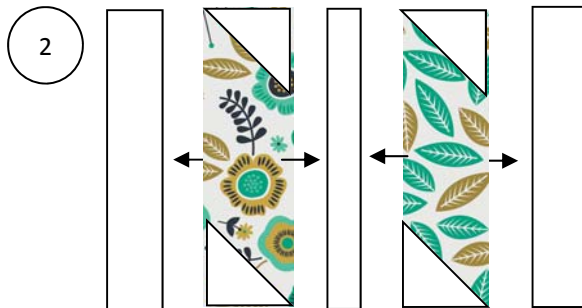

Aurifil thread suggestions:
#5605, #5158, #5975, #5865,
#5021, #5835



**Warm & Natural Batting: Full Bed
Sized package**