

# Pinwheel Snowflakes of Winter Joy

2009 Free "Christmas in July" 6 Month BOM Quilt Patterns from BOMQuilts.com & AbbiMays.com



Fabric Yardage - from AbbiMays.com  
"Winter Joy" from Clothworks



**Completed Quilt Size: 49" x 60" - Block Size: 15" finished, 15 1/2" unfinished**  
*Fabric requirements include the quilt top, borders and binding.*



Fabric	Cut (press toward the arrows)
Blue Swirls	FOUR 5 1/2" squares
Dk. Blue Tossed	FOUR 5 1/2" squares
White Swirls	TWO (2) 3 3/8" squares
Lt. Green Swirls	TWO (2) 3 3/8" squares

**Block 6**  
**Pinwheel**  
**Nine-Patch**

1

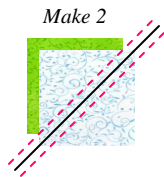

Make 2

Draw a diagonal line, corner-to-corner, on the back side of the White 3 3/8" squares. Place the squares on the 3 3/8" Lt. Green Swirl (right sides together) and sew 1/4" on EACH side of the line you drew. Then, cut the half-square triangles apart ON the line you drew.

2

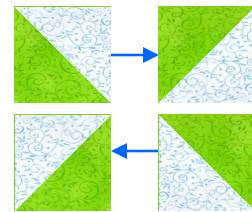

3

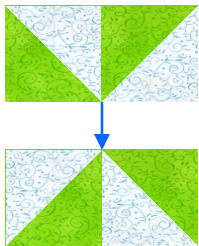

4

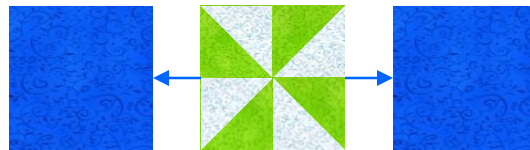

5

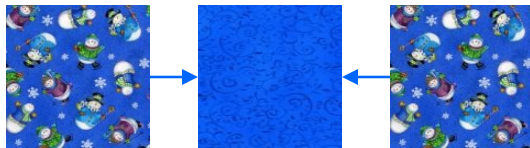

Make 2

6

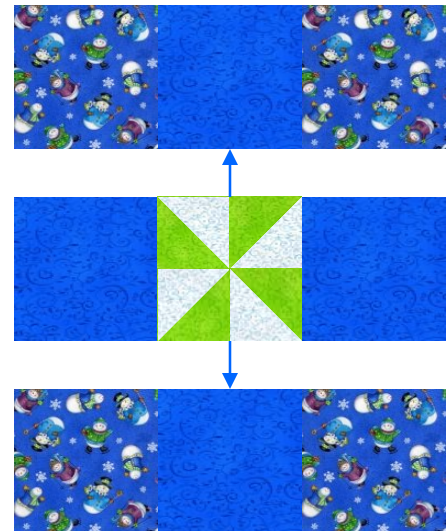

This pattern has been tested, to the best of our ability. If your block does not come out the size shown, please try adjusting your needle position to the appropriate position (left or right) and see if you get the correct block size.

# Pinwheel Snowflakes of Winter Joy

2009 Free "Christmas in July" 6 Month BOM Quilt Patterns from BOMQuilts.com & AbbiMays.com



Fabric Yardage - from AbbiMays.com  
"Winter Joy" from Clothworks



**Completed Quilt Size: 49" x 60" - Block Size: 15" finished, 15 1/2" unfinished**  
*Fabric requirements include the quilt top, borders and binding.*

## Completing Your Pinwheel Snowflakes of Winter Joy Quilt

Fabric	Cut (press toward the arrows)
Lt. Green Swirls	Cut THREE (3) 2 1/2" X 15 1/2" strips for the inside sashing for the blocks
Lt. Green Swirls	Cut FOUR (4) 2 1/2" x 32 1/2" strips for horizontal sashing
Lt. Green Swirls	Cut TWO (2) 2 1/2" x 47 1/2" strips for vertical sashing
Border Strip #1	Fussy-cut TWO (2) strips for first vertical (left & right) borders at 1 1/2" x 53 1/2" strips - you will ONLY add vertical border strips with this fussy-cut fabric choice
Border Strip #2	Fussy-cut TWO (2) strips for the second vertical (left & right) borders at 2 1/2" x 55 1/2" strips - you will ONLY add vertical border strips with this fussy-cut fabric choice
Border Strip #3	Fussy-cut TWO (2) strips for the horizontal (top & bottom) borders at 2 1/2" x 59 1/2" strips - you will ONLY add horizontal border strips with this fussy-cut choice
Binding	Cut enough 2 1/2" x WOF strips to bind your fabric, with whatever fabrics you choose and then piece them together so it will go around your finished quilt top

Completing Your Pinwheel Snowflakes of Winter Joy Quilt - follow the numbers below to add your sashing and borders to your quilt. Always press toward the new sashing or border fabric.

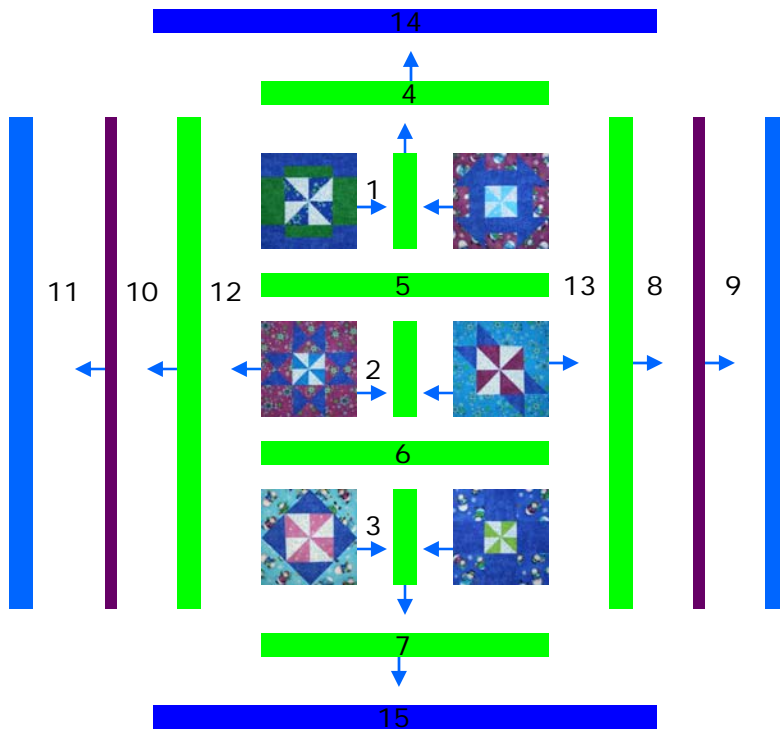

Now, you may create your quilt sandwich, quilt your top and add the binding!

We hope you enjoy this "Pinwheel Snowflakes" free & original BOMquilts.com Christmas in July project!

This pattern has been tested, to the best of our ability. If your block does not come out the size shown, please try adjusting your needle position to the appropriate position (left or right) and see if you get the correct block size.

© 2009 BOMQuilts.com - All Rights Reserved  
For Personal Use ONLY